

Vastu Shastra applicable to RESIDENTIAL SECTOR:

A) Vastu for Master Bedroom

- ❖ As per Vastu for Master Bedroom, it should always be in the South-West corner of the home and head of the family must occupy this bedroom.
- ❖ The master bedroom should always be bigger than other rooms of the house.
- ❖ If the house is multi-story then master bedroom in the South-West corner of the top floor is best.
- ❖ Vastu says that the master bedroom should only be used by married couples.
- ❖ South-West corner of the master bedroom should always be occupied.
- ❖ Hang a beautiful and pleasant painting or any portrait on the wall so that it is easily seen as someone enters the bedroom.

B) Vastu for Main Door

All the negative and positive energies surround here and which is why it is important to locate main gate in proper direction to maintain well-being and prosperity in house.

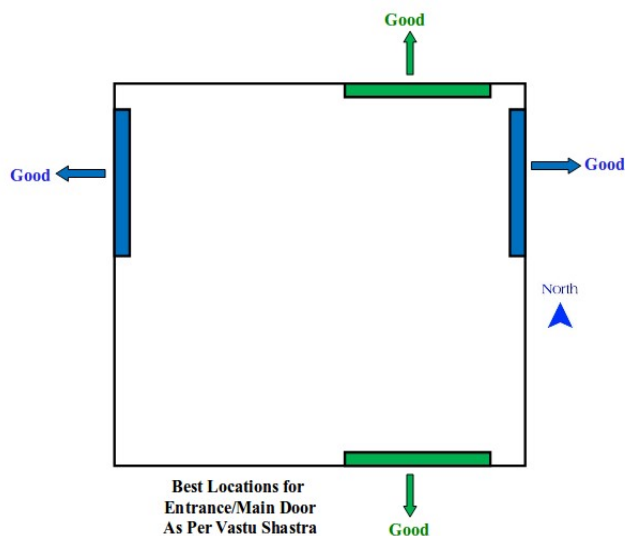

The above diagram helps you identify best locations for entrance door for a house as per vastu shastra.

- ❖ Main Door should be heavier, stronger and bigger than other doors of house.
- ❖ There should not be any obstruction in the entrance gate with things like poles, tree, wires and vehicles.
- ❖ Embellish main door with Om, Swastik, & flowers.
- ❖ No wall should obstruct in front of main gate.
- ❖ Avoid self-closing door.
- ❖ Always keep entrance door well lit with bright lights.

C) Vastu for which Side you should keep your head while sleeping?

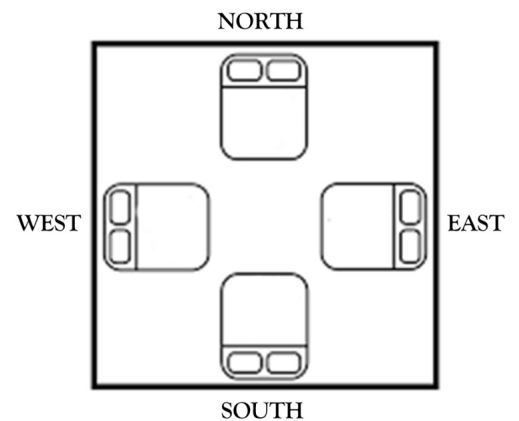

Sleeping with head towards the North

If a head of the person points towards the north while sleeping, North Poles of the body and Earth will repel each other, affecting the blood circulation. It causes stress, illness & also disturbs the mind.

Sleeping with head towards the East

Sleeping with head towards the east increases the memory power, concentration & also a good health.

Sleeping with head towards the West

It is called a neutral sleeping direction, as a result, it does not give a quality sleep required for freshness for the next day.

Sleeping with head towards the South

If a head of the person points towards the south while sleeping, it brings prosperity, good health, good fortune & a quality sleep.

D) Vastu for Water Element inside house

- ❖ The body of water should not be too huge compared to the actual premises or it can energetically dominate the site and weaken the occupant's growth.
- ❖ Shape and placement of the body of water are very important. Best place according to Vastu shastra is at north east zone. Waterfalls and fountains create new energy flow in any environment. A well placed fountain can have a beneficial impact on any space.
- ❖ Fish aquariums are also another powerful water energizer. Fish tanks are a combination of water and living energy which stimulates the flow of new energy flow.
- ❖ Avoid placing the fountain in the south-east area of the house or office, which is a location of the fire element and because water puts out the fire it can have a dampening effect on your finances.
- ❖ Finally, circulating or moving water is more powerful than stagnant water. Like a fountains placed at the front door can also deflect negative energy from entering the home.

G) Vastu for Doors and Windows

- ❖ According to Vastu, the windows and doors of a house must at all times be in even numbers such as 2, 4, 6, 8 etc. while avoiding 10.
- ❖ Doors should be adorned with auspicious decorative items such as Ganesha, Om, Laxmi, and Swastika pictures.
- ❖ Doors and windows should be placed opposite to each other so that both the positive and negative cycles are completed.
- ❖ Windows pointing towards the South-West direction should be avoided at any cost as the harmful, hot & penetrative ultraviolet rays of the sunlight are projected maximum in this direction.
- ❖ All the windows in your house should ideally be of uniform and consistent shape while also being proportionate in height and size as well.
- ❖ Automatic doors should be avoided at all costs. As per Vastu, doors which close automatically are said to affect the health of children.

E) Vastu for Kitchen

- ❖ There should be a single door for a kitchen and never should have two doors in opposite direction.
- ❖ The kitchen door should open in a clockwise manner & never in anti-clockwise direction.
- ❖ The door of the kitchen should be placed in the north-east, north, or in the east position.
- ❖ In the kitchen the larger window should be placed at the eastern side.

F) Vastu for Washroom

- ❖ Bathroom floor must never be on the same height as the bedroom and other rooms.
- ❖ Go for soothing colors like white, sky blue or light pastel shades.
- ❖ Sinks are best suited in the northeast, north or eastern sides, bathtubs must always be inclined towards northeast, west or eastern direction.
- ❖ Bathroom mirror has a strong sense of reflection and big size it can impact the energy flow mechanism of the bathroom if placed in a wrong direction.

#GetInTouch

P-40, Block B, Lake Town, Kolkata,
West Bengal 700089
(opposite:- Mansa Mandir)

www.insdkolkata.com |
enquiry@insdkolkata.com

 +91 62910 65177 / 033 4603 5028

     | INSD KOLKATA